

CRISIS RESPONSE PROTOCOL VICTORY SCHOOL

September 2013

A) Evacuation Locations:

- 1) Seven Oaks Middle School
- 2) Board Office and BZERC

B) Tornado (Severe Weather Alert) locations:

- Music & Gym – Central hallway adjacent to Room 3 & 4 close to walls
- Room 12 – boy’s washroom main hall (window-stay in stairwell)
- Room 14 – girl’s washroom main hall (as close to stairs as possible) (window-stay in stairwell)
- Rooms 15, 16, 17, 18 & 19 – hallway close to the walls and away from the windows
between Room 14 and Drinking Fountain
- Room 6 – girl’s washroom adjacent to staff room hall (window-stay in stairwell)
- Rooms 5 & 7 – grooming room
- Room 8 – hallway close to the walls in front of staff room
- Room 9 – boy’s washroom staff room hall (window-stay in stairwell)
- Room 1 & 2 – hallway adjacent to Room 4 and close to the walls or Mini - gym
- Room 10 – hallway by library

Students in wheelchairs in hall against the wall adjacent to the staff room

C) Gym Exits for Fire Drill:

The following gym seating plan will assist us in exiting the gym during a fire drill

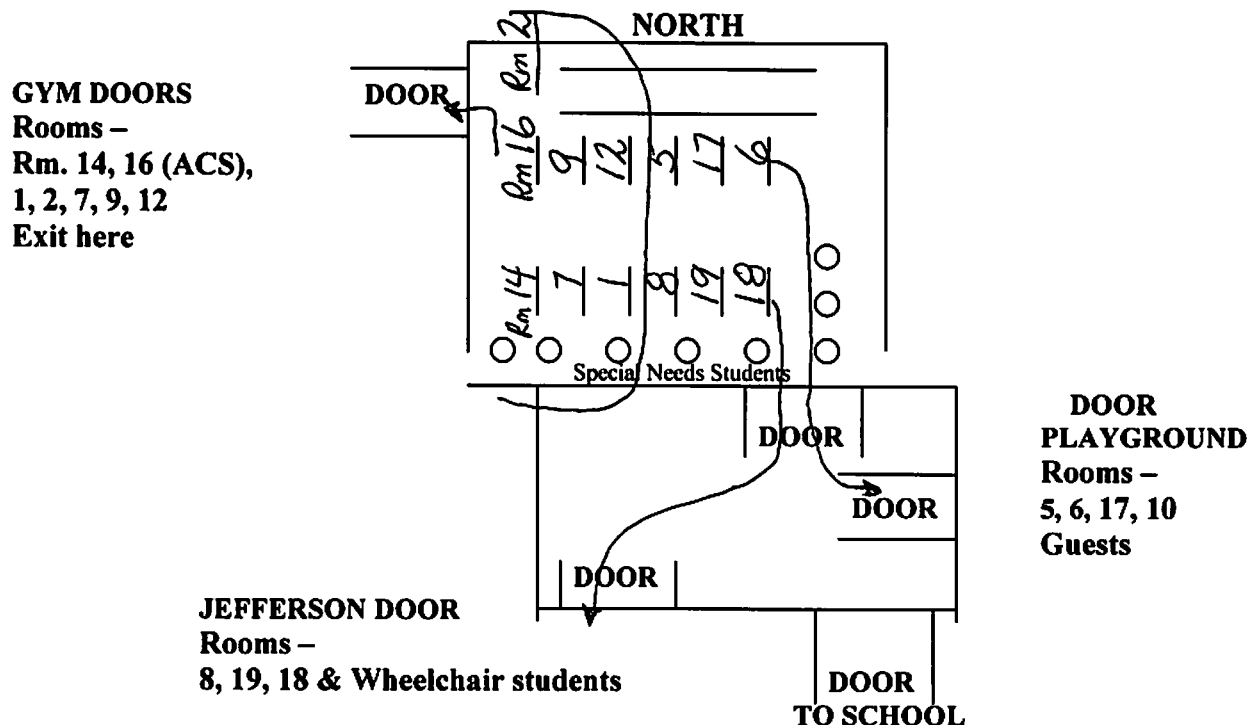

D) Intruder Alert

If there is an intruder in the school I will announce on the PA to lock your doors. Please ensure all students are in the classroom. (See Staff Information & Guidelines for details)

E) Evacuation

If we need to evacuate in the event of a bomb threat, I will announce that we need to leave the building and specify the time to leave. Exit by regular fire door exit unless notified otherwise. If the weather is severe we will evacuate to Seven Oaks Middle School by way of sidewalks. Students where walking is a difficulty will evacuate to the Board Office.

RISK MANAGEMENT BULLETIN

BEST PRACTICES

May 2000

Tornadoes

Environment Canada, Manitoba Emergency Measures Organization and MAST, have sponsored some awareness workshops on Summer Storms. A number of schools have been practicing various techniques learned at those workshops. These include conducting tornado drills within the school. The following information will help schools to be better prepared for tornadoes.

Tornado Watches and Warnings

A **tornado watch** is issued by Environment Canada when tornadoes are possible in your area. Remain alert for approaching storms. This is the time to remind staff members where the safest places within your school are located, and listen to the radio or television for further developments.

A **tornado warning** is issued when a tornado has been sighted or indicated by weather radar. If a tornado warning is issued for your area and the sky becomes threatening, move to your pre-designated place of safety. Turn on a battery-operated radio and wait for further instructions.

Tornado Danger Signs

Look out for:

- Dark, often greenish sky
- Wall cloud
- Large hail
- Loud roar; similar to a freight train

Caution:

- Some tornadoes appear as a visible funnel extending only partially to the ground. Look for signs of debris below the visible funnel.
- Some tornadoes are clearly visible, while others are obscured by rain or nearby low-hanging clouds.
- Before a tornado hits, the wind may die down and the air may become very still.
- An approaching cloud of debris can mark the location of a tornado even if a funnel is not visible.
- Tornadoes generally occur near the trailing edge of a thunderstorm. It is not uncommon to see clear, sunlit skies behind a tornado.

Designate areas in the school as shelter areas and practice having everyone go there in response to a tornado threat. Recognize that hydro may be out and have a whistle available in case the PA or alarm bells cannot function.

At School:	If Outdoors:	If in a car:
<ul style="list-style-type: none"> • Go to the basement or to an inside hallway at the lowest level. Change rooms and washrooms are ideal places in most schools. Stay away from large glass areas. • Avoid places with wide-span roofs such as auditoriums and cafeterias. • Get under a piece of sturdy furniture such as a workbench or heavy table or desk and hold on to it. • Use arms to protect head and neck. 	<ul style="list-style-type: none"> • If possible, get inside a building. • If shelter is not available or there is no time to get indoors, lie in a ditch or low-lying area or crouch near a strong building. Be aware of the potential for flooding. • Use arms to protect head and neck. 	<ul style="list-style-type: none"> • <i>Never</i> try to out drive a tornado in a car or truck. Tornadoes can change direction quickly and can lift up a car or truck and toss it through the air. • Get out of the car immediately and take shelter in a nearby building. • If there is no time to get indoors, get out of the car and lie in a ditch or low-lying area <i>away</i> from the vehicle. Be aware of the potential for flooding.

The attached photographs show students at Noël-Ritchot School in St. Norbert during a practice drill. One photo shows students huddled under the wash basins in a change room and the other shows students under tables in a library.

Remember – Manitoba has tornadoes every year and the entire province has at some time experienced a tornado.

When a tornado is coming, you have only a short amount of time to make life or death decisions. Advance planning and quick response are the keys to surviving a tornado.

