

THIS DRAWING MUST NOT BE SCALED. A DIGITAL DRAWING FILE WILL BE PROVIDED TO THE GENERAL CONTRACTOR FOR LAYOUT OF WORKS VIA TOTAL STATION OR SIMILAR METHODS.

THE GENERAL CONTRACTOR SHALL VERIFY ALL DIMENSIONS, DATUMS AND LEVELS PRIOR TO COMMENCEMENT OF WORK. ALL ERRORS AND OMISSIONS TO BE REPORTED IMMEDIATELY TO THE LANDSCAPE ARCHITECT.

VARIATIONS & MODIFICATIONS TO WORK SHOWN ON THESE DRAWINGS SHALL NOT BE CARRIED OUT WITHOUT WRITTEN PERMISSION FROM THE LANDSCAPE ARCHITECT.

THIS DRAWING IS THE EXCLUSIVE PROPERTY OF THE LANDSCAPE ARCHITECTS AND CAN BE REPRODUCED ONLY WITH THE PERMISSION OF THE LANDSCAPE ARCHITECTS. IN WHICH CASE THE REPRODUCTION MUST BEAR THEIR NAME AS LANDSCAPE ARCHITECTS.

issue / rev.

issue / rev.	date	issue notes
1	2018.06.06	ISSUED FOR 66% REVIEW
1	2018.01.25	ISSUED FOR 30% REVIEW
#	date	issue notes

professional seals

project information

SEVEN OAKS AGRICULTURAL LEARNING CENTRE

1985 Grassmere Road
 West St. Paul, MB
 Canada

client

SEVEN OAKS SCHOOL DIVISION
 630 POWERS ST.
 WINNIPEG, MB

drawing information

SITE PLAN

drawn by: **KB**
 approved by: **BD**

scale: **1:1500**
 date issued: **2018.06.06**
 proj. #: **18-007**
 rev. #: **R0**

SEVEN OAKS AGRICULTURAL LEARNING CENTRE
 1985 GRASSMERE ROAD

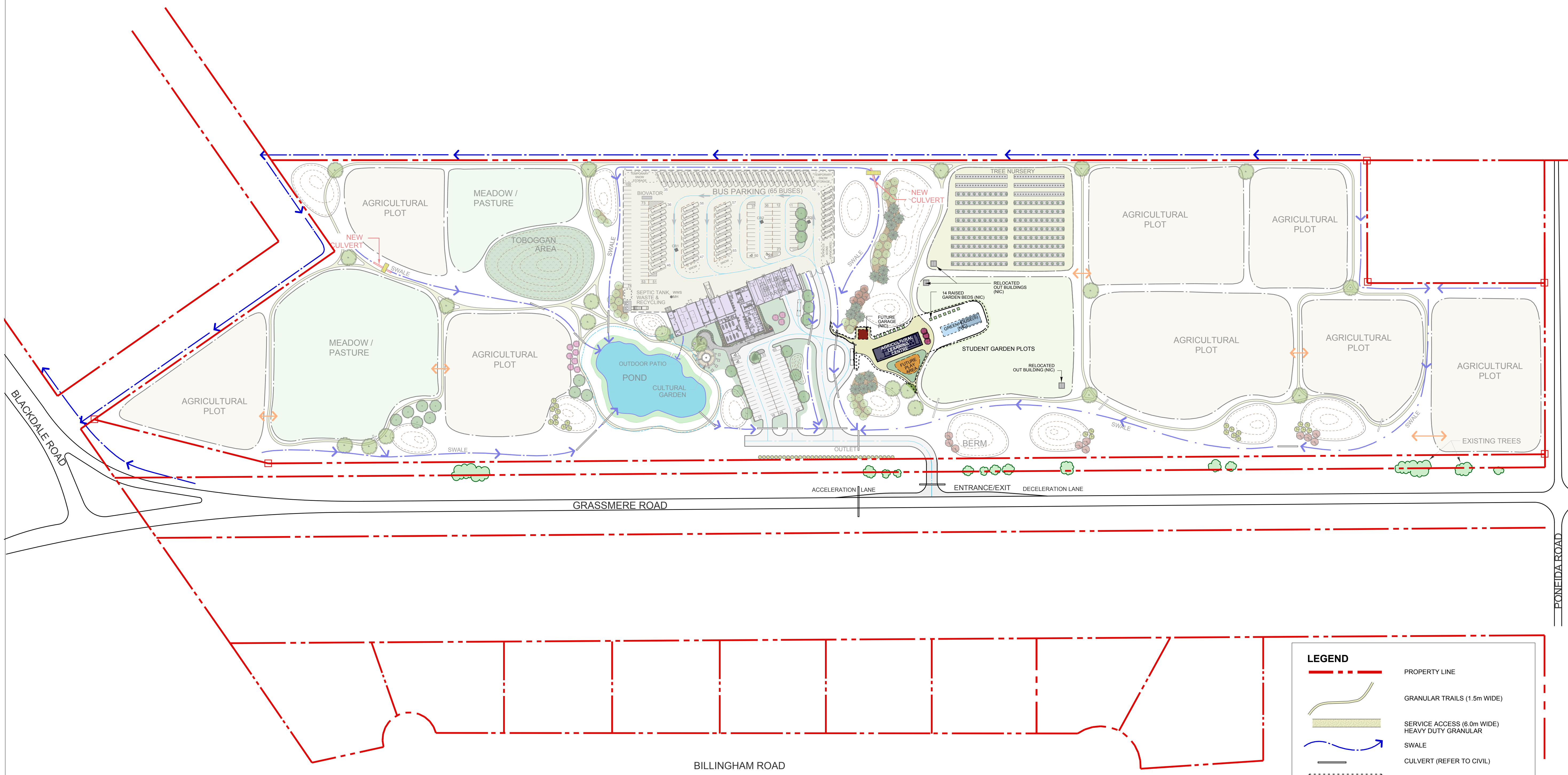

***NOTE:**
 EXCAVATION AND ROUGH GRADING FOR ALL BERMS, AGRICULTURAL PLOTS, AND SWALES ARE INCLUDED IN THE BASE BID FOR PHASE ONE.

LEGEND

- PROPERTY LINE
- GRANULAR TRAILS (1.5m WIDE)
- SERVICE ACCESS (6.0m WIDE) HEAVY DUTY GRANULAR
- SWALE
- CULVERT (REFER TO CIVIL)
- STUDENT GARDEN PLOTS
- EXISTING TREES TO REMAIN
- PROPOSED SHRUB PLANTING
- PROPOSED TREE PLANTING
- BERM
- TRACTOR CROSSING - FIELD ACCESS
- TRACTOR CROSSING - AT SWALE + CULVERT
- NEW CULVERT

SCALE: 1:1500
 0 5 10 20 50m

